

WONDFO BIOTECH
WeAreWorkingForYour **Health**



Guangzhou Wondfo Biotech Co., Ltd.
No. 8 Lizhishan Road, Science City,
Luogang District, 510663 Guangzhou, P.R.China
Tel: (+86) 400-830-8768
Website: en.wondfo.com.cn
E-mail: sales@wondfo.com.cn



Rev. A2 Rel.: 2022/05/07



cTnT

Troponin T

Finecare

One Step cTnT RAPID QUANTITATIVE TEST

For Timely and Better AMI Diagnosis

One Step cTnT Rapid Quantitative Test

- ✓ Internationally recognized gold standard for AMI diagnosis
- ✓ Good sensitivity and specificity for early myocardial infarction
- ✓ Supports whole blood/serum/plasma sample type
- ✓ Room temperature storage up to 24 months
- ✓ One step operation, streamline the workflow

CLINICAL APPLICATION

Diagnose

AHA/ACC : cardiac specific troponin levels should be measured at presentation and 3 to 6 hours after symptom onset.

Monitoring

Change value from serial troponin tests for better monitoring and making decision. Admission (0 h), 3, and 6 h serial Troponin test are preferred for clinicians in ED.

Prognosis

An elevated troponin level can identify patients at high risk. Higher mortality is correlating with the degree of troponin elevation in ICU patients.

Application scenarios



Lab



Cardiology



ICU



Emergency Department
Ambulance



Primary care



Chest pain center

ITEMS SPECIFICATION

Item	Catalog No.	Sample Type	Reaction Time	Detection Range	Storage
One Step cTnT	W254P0001	75µL serum/plasma or 100µL whole blood	15minutes	0.03~10ng/mL	4~30°C for 24 months

TEST PROCEDURE

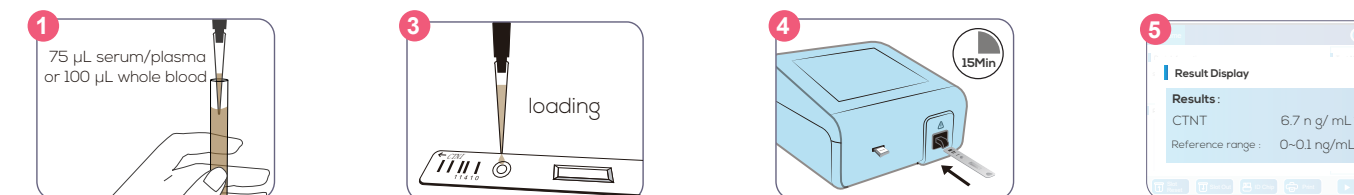

ADAPTATION INSTRUMENTS

1. Finecare™ FIA Meter Plus (FS-113)
2. Finecare™ II Plus SE (FS-114)
3. Finecare™ III Plus (FS-205)

